



PARALLEL TESTING DEVICE

COMPETENCE IN MEASUREMENT ENGINEERING



Management System
ISO 9001:2015

www.tuv.com
ID: 0091005312



PAULWEGENER
MESSTECHNIK SEIT 1921

TECHNICAL DATA SHEET

Parallel testing device

The parallel testing device is used for pressure measurement at gas and water pipelines.

Generated by a compressor, the required test pressure is pumped into the test object via multipurpose hose.

Pressure change thereby will be visible on the connected pressure gauge. Once the test pressure has been reached, the ball valve will be closed so that the leak test can be performed at the test object.

A specified testing period must be kept to be able to perform the test correctly.

The attached pressure transducer* is connected to a data logger* where performance data are stored.

An online interface at the data logger* enables connection to the PC/laptop where data can be evaluated by the software PWB-Soft.

Equipment

Crosspiece 4xG1/2" internal thread
Ball valve 1/2" PN 40, 1xG1/2 external thread,
1xG1/2" internal thread
Multi-Sevis hose 2m, 2xG1/2" external thread
Locking coupling type 25, G1/2" external thread
Plug nipple type 25, G1/2" external thread
Pressure gauge 0...25 bar, nominal size 100,
cl. 0,6; G1/2 external thread
Rubber protection cap, nominal size 100
Carrying case (plastic)

Options

Customized effective ranges
Other connecting conditions on request
Data loggers for performance data storage on request

Further options and accessories

Adapter

locking coupling type 25
with G1/2" internal thread

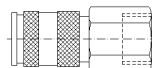

Adapter

plug nipple type 25
with G1/2" internal thread



Pressure transducer DS 1/40
with plug nipple type 25

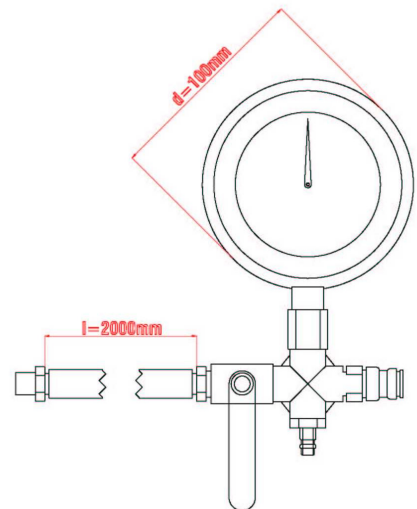
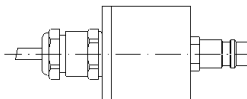

Händlerstempel



PAULWEGENER
MESSTECHNIK SEIT 1921

Adresse | Paul Wegener GmbH | Marienstraße 24 | 06493 Ballenstedt
Telefon | +49 39483 96-300
Fax | +49 39483 96-400
Internet | www.paul-wegener.de
E-Mail | info@paul-wegener.de